

136596
M-550

Formerly Utilized Sites Remedial Action Program (FUSRAP)

ADMINISTRATIVE RECORD

for Maywood, New Jersey



U.S. Department of Energy

ornl

ORNL/RASA-85/34

**OAK RIDGE
NATIONAL
LABORATORY**

MARTIN MARIETTA

RESULTS OF THE RADIOLOGICAL SURVEY AT
45 KIPP AVENUE (LJ020), LODI, NEW JERSEY

OPERATED BY
MARTIN MARIETTA ENERGY SYSTEMS, INC.
FOR THE UNITED STATES
DEPARTMENT OF ENERGY

Access to the information in this report is limited to those
indicated on the distribution list and to Department of Energy
and Department of Energy Contractors

This report was prepared as an account of work sponsored by an agency of the United States Government. Neither the United States Government nor any agency thereof, nor any of their employees, makes any warranty, express or implied, or assumes any legal liability or responsibility for the accuracy, completeness, or usefulness of any information, apparatus, product, or process disclosed, or represents that its use would not infringe privately owned rights. Reference herein to any specific commercial product, process, or service by trade name, trademark, manufacturer, or otherwise, does not necessarily constitute or imply its endorsement, recommendation, or favoring by the United States Government or any agency thereof. The views and opinions of authors expressed herein do not necessarily state or reflect those of the United States Government or any agency thereof.

HEALTH AND SAFETY RESEARCH DIVISION

**Nuclear and Chemical Waste Programs
(Activity No. AH 10 05 00 0; ONLWC01)**

**RESULTS OF THE RADIOLOGICAL SURVEY AT
45 KIPP AVENUE (LJ020), LODI, NEW JERSEY**

R. W. Doane

Date of Issue - December 1985

Investigation Team

**B. A. Berven - RASA Program Manager
W. D. Cottrell - FUSRAP Project Director
R. W. Doane - Field Survey Supervisor**

Survey Team Members

**A. C. Butler
B. S. Ellis
K. P. Monar**

**Work performed as part of the
RADIOLOGICAL SURVEY ACTIVITIES PROGRAM**

**Prepared by the
OAK RIDGE NATIONAL LABORATORY
Oak Ridge, Tennessee 37831
operated by
MARTIN MARIETTA ENERGY SYSTEMS, INC.
for the
U. S. DEPARTMENT OF ENERGY
under Contract No. DE-AC05-84OR21400**

CONTENTS

	<u>Page</u>
LIST OF FIGURES AND TABLES	v
ACKNOWLEDGEMENTS	vii
INTRODUCTION	1
SURVEY METHODS	1
SURVEY RESULTS	1
Systematic and Biased Soil Samples.	2
Gamma Radiation Levels.	2
SUMMARY.	2
REFERENCES	3

LIST OF FIGURES AND TABLES

<u>Figure</u>		<u>Page</u>
1	Diagram showing locations of soil samples taken at 45 Kipp Avenue, Lodi, New Jersey.	4
2	Gamma radiation levels measured at 45 Kipp Avenue, Lodi, New Jersey.	5

<u>Table</u>		<u>Page</u>
1	A summary of applicable radiation guidelines.	6
2	Background radiation levels for the northern New Jersey area	7
3	Concentrations of radionuclides in soil at 45 Kipp Avenue, Lodi, New Jersey.	8

ACKNOWLEDGEMENTS

Research for this project was sponsored by the Division of Remedial Action Projects, U.S. Department of Energy. The author wishes to acknowledge the support of J. E. Baublitz, Director, Division of Facility & Site Decommissioning Projects, E. G. DeLaney, Manager, FUSRAP/Surplus Facilities Group, and members of their staff. In addition, the author appreciates the manuscript preparation by S. E. Huckaba.

RESULTS OF THE RADIOLOGICAL SURVEY AT
45 KIPP AVENUE, LODI, NEW JERSEY*

INTRODUCTION

A radiological survey of 45 Kipp Avenue, Lodi, New Jersey, was conducted by a survey team from Oak Ridge National Laboratory (ORNL) on April 12, 1985 at the request of the Department of Energy (DOE). This property was identified as being suspected of having contaminated material present during the mobile gamma scan of Lodi, New Jersey.¹

The radiological survey conducted on this property was for the purpose of determining whether the property had any radioactive material onsite in excess of background radiation levels, and, if so, were these radioactive materials in excess of remedial action guidelines established by DOE such that the property could be "designated" for further investigation. This report summarizes the results of the "designation" survey performed on this property.

SURVEY METHODS

The radiological survey of the property included: (1) a gamma scan of the entire property outdoors; and (2) sampling of surface (0-15 cm) soil. No indoor survey measurements were performed. These survey methods followed the plan outlined in Reference 2. A comprehensive description of the survey methods and instrumentation has been presented in another report.³

SURVEY RESULTS

Applicable federal guidelines have been summarized in Table 1. The normal background levels for the northern New Jersey area are presented in Table 2. These data are provided for comparison with the survey results presented in this section. All direct measurement results presented in this report are gross readings at ground surface;

* The survey was performed by members of the Radiological Survey Activities Group of the Health and Safety Research Division at Oak Ridge National Laboratory under DOE contract DE-AC05-84OR21400.

background radiation levels have not been subtracted. Similarly, background concentrations have not been subtracted from radionuclide concentrations measured in environmental samples.

Systematic and Biased Soil Samples

Systematic and biased soil samples were taken from various locations on the property for radionuclide analyses. Locations of the systematic (LJ20S) and biased (LJ20B) samples are shown in Fig. 1, with results of laboratory analyses provided in Table 3. Concentrations of uranium, radium, and thorium were within normal background levels in both systematic samples. Concentrations of uranium and radium were slightly elevated in both biased soil samples which ranged from 3.4 pCi/g to 4.2 pCi/g and 12 pCi/g to 13 pCi/g, respectively. Concentrations of ^{232}Th were within normal background levels in both biased soil samples. Concentrations of ^{226}Ra exceed those for ^{238}U in the biased samples but are believed to be due to naturally-occurring material.

Gamma Radiation Levels

Results of the gamma scan of the surface of the property behind the retaining walls showed no gamma exposure rates in excess of background radiation levels (6 $\mu\text{R/h}$ to 9 $\mu\text{R/h}$). Locations and exposure rates are shown in Fig. 2. Maximum gamma exposure rates of 17-21 $\mu\text{R/h}$ were measured on the northwest corner of this property and cover approximately 350 square feet. These results locate areas where ^{238}U -bearing material exists.

SUMMARY

Measurements taken at 45 Kipp Avenue indicate that the property contains some radioactive contamination primarily from the ^{238}U decay chain. This material was found in the locations shown in Fig. 2. However, the majority of the property is within normal background radiation levels. While the ratios of ^{238}U and ^{226}Ra are not in total equilibrium, it is believed that this is naturally-occurring material. Further investigation may be required to determine if this uraniferous material is an outcrop of uranium ore material which is native to this area of northern New Jersey.

REFERENCES

1. R. W. Doane and B. A. Berven, "Results of the Mobile Gamma Scanning Activities in Lodi, New Jersey," Oak Ridge National Laboratory, ORNL/RASA-84/3 (October 1984).
2. W. D. Cottrell, ORNL, to A. J. Whitman, DOE/HQ, correspondence, "Radiological Survey of Private Properties in Lodi, New Jersey" (August 15, 1984).
3. Oak Ridge National Laboratory, Procedures Manual for the ORNL Remedial Action Survey and Certification Activities (RASCA) Program, ORNL/TM-8600 (October 1982).
4. U.S. Department of Energy, Radiological Survey of the Middlesex Municipal Landfill, Middlesex, New Jersey, DOE/EV-0005/20, April 1980.
5. T. E. Myrick and B. A. Berven, State Background Radiation Levels: Results of Measurements Taken During 1975-1979, Oak Ridge National Laboratory, ORNL/TM-7343 (November 1981).

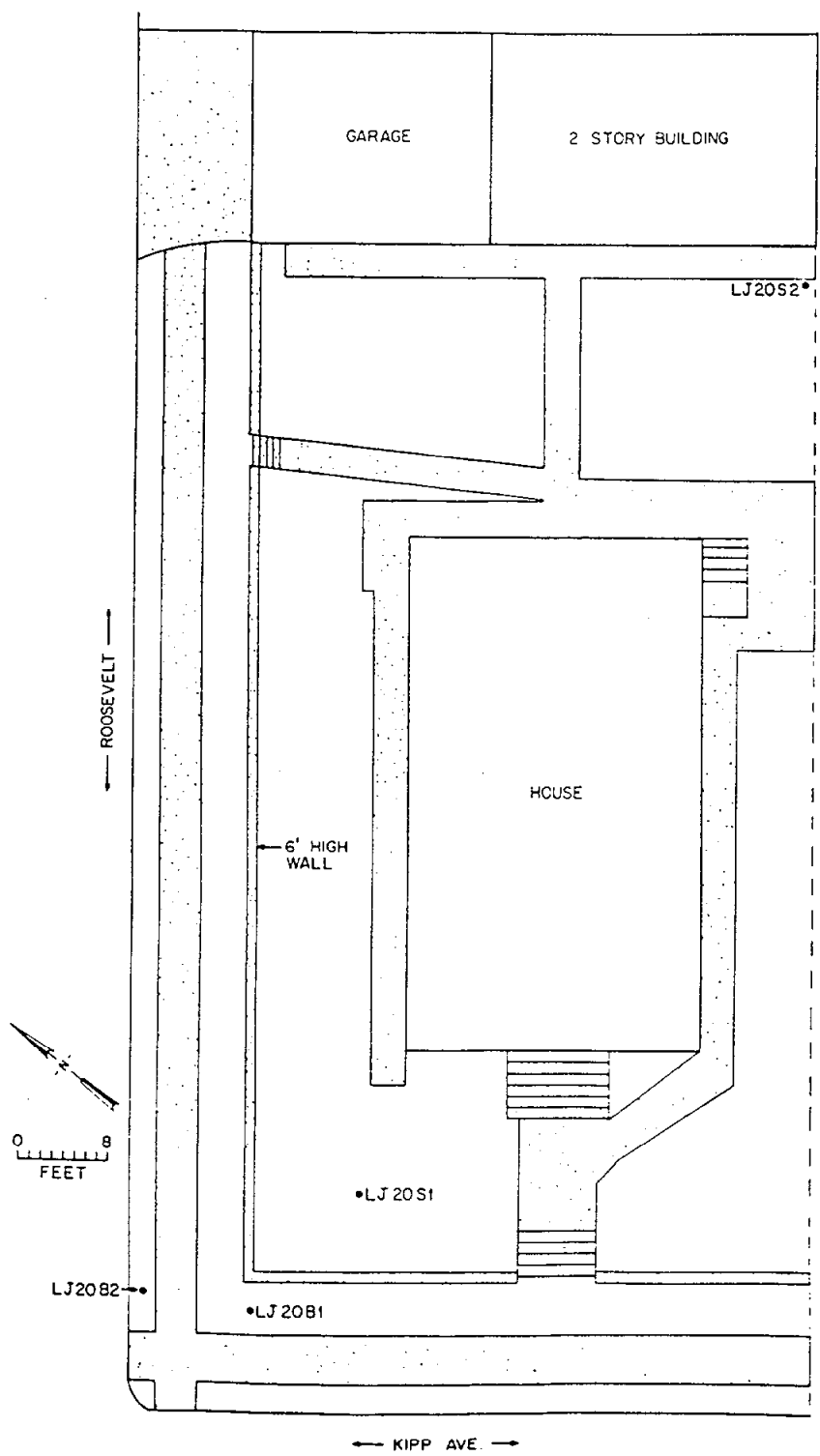

Fig. 1. Diagram showing locations of soil samples taken at 45 Kipp Avenue, Lodi, New Jersey.

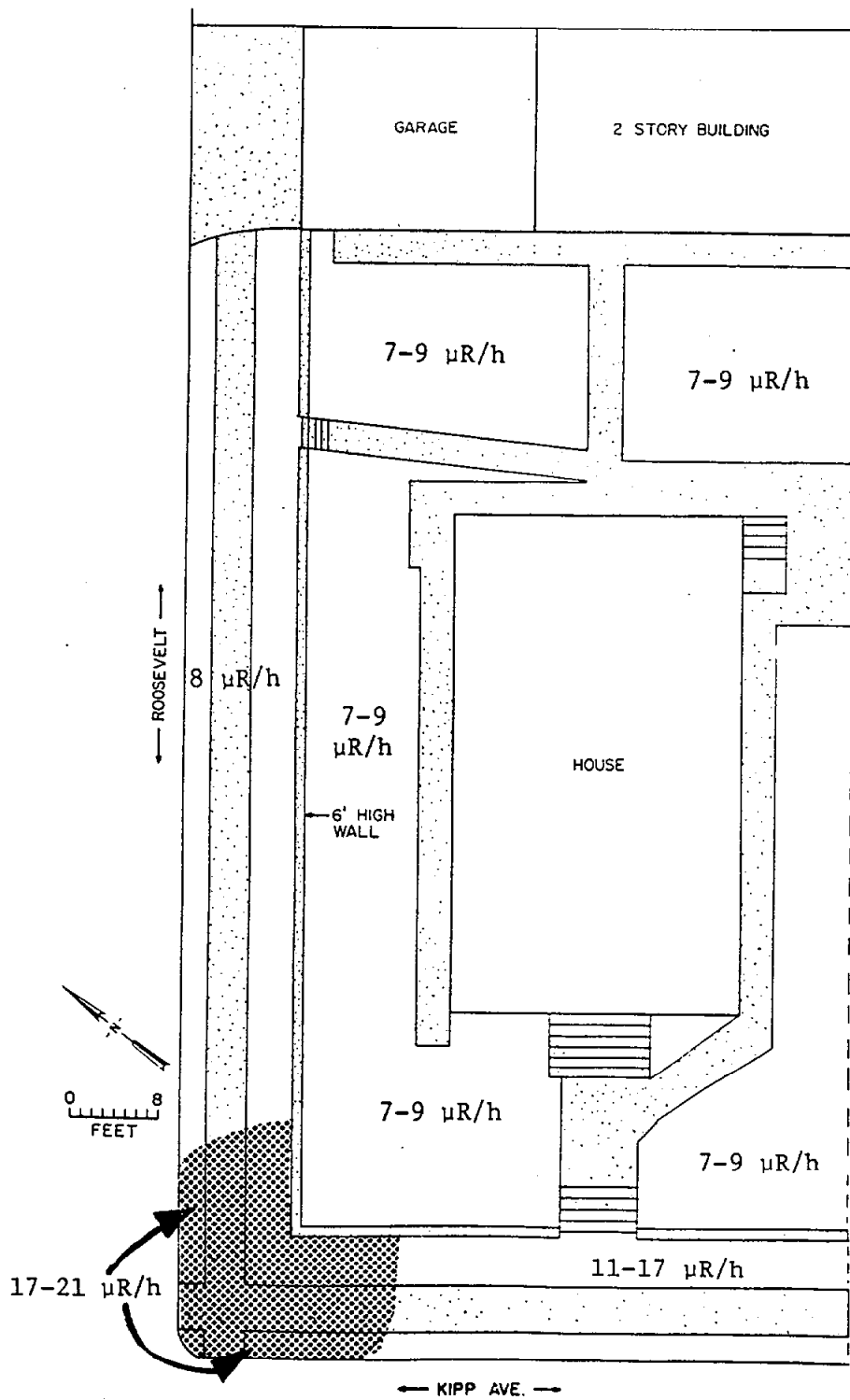

Fig. 2. Gamma radiation levels measured at 45 Kipp Avenue, Lodi, New Jersey.

Table 1. A summary of applicable radiation guidelines for the FUSRAP program (July 1985).

Mode of exposure	Exposure conditions	Guideline value	Guideline source
1. Gamma radiation	Continuous exposure to individual in general population (whole body)	57 μ R/h	DOE Order 5480.1A Chapter 11 Requirements for Radiation Protection
2. Radionuclide concentrations in soil	Maximum permissible concentration of the following radionuclides in soil above background levels averaged over 100 m ² area ^{226}Ra ^{232}Th	5 pCi/g averaged over the first 15 cm of soil below the surface; 15 pCi/g when averaged over 15-cm thick soil layers more than 15 cm below the surface and less than 1.5 m below the surface	U.S. Department of Energy Guidelines for Residual Radioactivity at Formerly Utilized Sites Remedial Action Program and Remote Surplus Facilities Management Program Sites (Revision 1, July 1985)

00000001

Table 2. Background radiation levels for the northern New Jersey area.

Type or radiation measurement or sample	Radiation level or radionuclide concentration
Gamma exposure rate at 1 m above floor or ground surface ($\mu\text{R/h}$)	8 ^a
Concentration of radionuclides in soil (pCi/g)	
²³² Th	0.9 ^b
²³⁸ U	0.9 ^b
²²⁶ Ra	0.9 ^b

^aReference 4.^bReference 5.

Table 3. Concentrations of radionuclides in soil at 45 Kipp Avenue, Lodi, New Jersey.

Sample ^a	Depth (cm)	Radionuclide concentration (pCi/g)		
		²²⁶ Ra ^b	²³² Th ^b	²³⁸ U ^c
<u>Systematic samples</u>				
LJ20S1	0 - 15	1.0 ± 0.08	0.96 ± 0.2	0.86
LJ20S2	0 - 15	0.91 ± 0.2	1.0 ± 0.3	0.89
<u>Biased samples^d</u>				
LJ20B1	0 - 15	12 ± 0.3	1.2 ± 0.5	4.2
LJ20B2	0 - 15	13 ± 0.7	1.4 ± 0.7	3.4

^aLocations of soil samples are shown on Fig. 1.

^bIndicated counting error is at the 95% confidence level ($\pm 2 \sigma$).

^cTotal analytical error of measurement results is less than $\pm 5\%$ (95% confidence level).

^dBiased samples are taken from areas shown to have elevated gamma exposure rates.

INTERNAL DISTRIBUTION

- | | | | |
|-------|----------------|-----|--------------------------|
| 1-3. | B. A. Berven | 12. | P. T. Owen |
| 4. | R. O. Chester | 13. | T. H. Row |
| 5. | W. D. Cottrell | 14. | IR&A Publications Office |
| 6-10. | R. W. Doane | 15. | Laboratory Records - RC |
| 11. | S. V. Kaye | | |

EXTERNAL DISTRIBUTION

16. J. D. Berger, Oak Ridge Associated Universities, P. O. Box 117, Oak Ridge, TN 37831
- 17-26. Edward DeLaney, U.S. Department of Energy, 19901 Germantown Road, Germantown, MD 20874
- 27-29. E. L. Keller, U.S. Department of Energy, P. O. Box E, Oak Ridge, TN 37831
- 30-32. J. F. Nemec, Bechtel National, Inc., 800 Oak Ridge Turnpike, Oak Ridge, TN 37831
33. Office of Assistant Manager, Energy Research and Development, Oak Ridge Operations Office, Oak Ridge, TN 37831
- 34-35. Office of Scientific and Technical Information, DOE, Oak Ridge, TN 37831