Formerly Utilized Sites Remedial Action Program (FUSRAP)

ADMINISTRATIVE RECORD

for the Maywood Site, New Jersey



**US Army Corps
of Engineers®**

ornl

**OAK RIDGE
NATIONAL
LABORATORY**

MARTIN MARIETTA

OPERATED BY
MARTIN MARIETTA ENERGY SYSTEMS, INC.
FOR THE UNITED STATES
DEPARTMENT OF ENERGY

RECEIVED

SEP 9 8 49 AM '86

T. H. ROW
ORNL

M-752

ORNL/RASA-86/45
(MJ06L)

**RESULTS OF THE
INDEPENDENT RADIOLOGICAL
VERIFICATION SURVEY**

AT
30 GROVE AVENUE, ROCHELLE PARK,
NEW JERSEY (MJ06L)

M. G. Yalcintas
C. A. Johnson

054414

ORNL/RASA-86/45
(MJ06L)

HEALTH AND SAFETY RESEARCH DIVISION

Nuclear and Chemical Waste Programs
(Activity No. AH 10 05 00 0; ONLWC01)

RESULTS OF THE INDEPENDENT
RADIOLOGICAL VERIFICATION SURVEY
AT
30 GROVE AVENUE, ROCHELLE PARK,
NEW JERSEY (MJ06L)

M. G. Yalcintas
C. A. Johnson*

*Biology Division

Date of Issue — August 1986

Investigation Team

B. A. Berven — RASA Program Manager
W. D. Cottrell — FUSRAP Project Director
M. G. Yalcintas — Field Survey Supervisor

Work performed as part of the
RADIOLOGICAL SURVEY ACTIVITIES PROGRAM

Prepared by the
OAK RIDGE NATIONAL LABORATORY
Oak Ridge, Tennessee 37831
operated by
MARTIN MARIETTA ENERGY SYSTEMS, INC.
for the
U.S. DEPARTMENT OF ENERGY
under Contract No. DE-AC05-84OR21400

CONTENTS

	Page
LIST OF FIGURES	v
LIST OF TABLES	vii
ACKNOWLEDGMENTS	ix
INTRODUCTION	1
PROCEDURES	2
Objectives	2
Document Reviews	2
VERIFICATION SURVEY AND ANALYSIS	2
Gamma Measurements	3
Soil Sampling	3
CONCLUSION	4
REFERENCES	5

LIST OF FIGURES

Figure		Page
1	Vicinity properties in the Rochelle Park, New Jersey, area	6
2	Diagram showing grid point and grid block locations outdoors on the property at 30 Grove Ave., Rochelle Park, New Jersey (MJ06L)	7
3	Locations of soil samples on the property at 30 Grove Ave., Rochelle Park, New Jersey (MJ06L)	8

LIST OF TABLES

Table		Page
1	Summary of residual contamination guidelines for the Rochelle Park, New Jersey, site	9
2	Background radiation levels in the Rochelle Park, New Jersey, area	11
3	Result and location of the pressurized ionization chamber (PIC) measurement at 30 Grove Ave., Rochelle Park, New Jersey (MJ06L)	11
4	Results of soil sample analysis at 30 Grove Ave., Rochelle Park, New Jersey (MJ06L)	12

ACKNOWLEDGMENTS

Research for this project was sponsored by the Division of Facility and Site Decommissioning Projects, U.S. Department of Energy. The authors wish to acknowledge the support of J. E. Baublitz, Deputy Director, Office of Remedial Action and Waste Technology, E. G. DeLaney, Director, Division of Facility and Site Decommissioning Projects, and members of their staff. The authors recognize the valuable contributions of C. Leichtweis of Bechtel National, Inc. (BNI), for providing the data collected by BNI during the remedial action and T. R. Stewart of the RASA group for assisting during the preparation of this report. In addition, the authors appreciate the manuscript preparation by S. E. Huckaba, RASA, J. W. Crutcher, Biology Division, and S. W. Hawthorne and B. C. Littleton, Information Resources Organization.

RESULTS OF THE INDEPENDENT RADIOLOGICAL VERIFICATION SURVEY AT 30 GROVE AVENUE, ROCHELLE PARK, NEW JERSEY (MJ06L)*

INTRODUCTION

Processing of thorium ores was performed in Maywood, New Jersey, between 1916 and 1956 by the Maywood Chemical Works.¹ During the course of thorium processing the wastes from the operations were pumped to diked areas west of the plant. Additional material was placed in two piles surrounded by earthen dikes. In 1932, Route 17 was built through this disposal area. The Maywood Chemical Works ceased thorium processing in 1956 and subsequently was sold to Stepan Chemical Company in 1959. After 1963, on several occasions wastes were removed from the west side of New Jersey Route 17. In 1984, the U.S. Department of Energy (DOE) was assigned the responsibility by Congress for the decontamination project involving the site and vicinity properties in Maywood and Rochelle Park under the Formerly Utilized Sites Remedial Action Program (FUSRAP).

This site, referred to as the Maywood site, had surface and subsurface radionuclide concentrations in excess of the DOE criteria listed in Table 1. This site is now owned by Ballod and Associates. It has been identified through radiological assessment procedures by Oak Ridge Associated Universities and Nuclear Safety Associates, Inc.,^{1,2} for the purpose of decontamination based on DOE's remedial action objectives. The Maywood site and vicinity properties, which include the residential properties on Grove Avenue and Park Way in Rochelle Park, were assigned by DOE to FUSRAP although the contamination at the Maywood site did not result from the Atomic Energy Program.

From June to December, 1984, Bechtel National, Inc. (BNI), the project management contractor designated by DOE, performed remedial action on this residential property. This remedial action is on one of ten designated properties in the Rochelle Park area (Fig. 1). Based on drawings showing the extent of contamination, the property was excavated and the contaminated material transported to the Maywood Interim Storage Site (MISS), adjacent to the Stepan Company plant.³ After removal of all contaminated soil, the property was restored to its original condition. By using a combination of procedures, the contamination was controlled and prevented from spreading to other areas. A post-remedial radiological survey was conducted by BNI to ensure compliance with DOE remedial action guidelines.⁴

The DOE adopted a policy to assign an independent verification contractor to ensure the effectiveness of remedial actions performed within FUSRAP. The Radiological Survey Activities Group of Oak Ridge National Laboratory (ORNL) has been assigned the responsibility for this task at the Maywood site. This report describes the methods and results of that verification.

*The survey was performed by members of the Radiological Survey Activities Group of the Health and Safety Research Division at Oak Ridge National Laboratory under DOE contract DE-AC05-84OR21400 with Martin Marietta Energy Systems, Inc.

From January to June, 1986, ORNL conducted the verification activity for the Rochelle Park properties, including this location at 30 Grove Ave., which adjoins the Ballod property. A diagram of the property showing the approximate property boundaries and grid network established for measurements outside the buildings is shown in Fig. 2. This location is one in a series of vicinity properties near the Maywood site that was suspected of being radioactively contaminated and that has been surveyed by BNI³ to identify horizontal and vertical boundaries of radionuclide concentrations exceeding remedial action criteria. (Verification of these properties will be completed in 1986.) A contaminated area of ~100 m² that exceeded the guidelines was located in the backyard of the property and was excavated.

PROCEDURES

Objectives

The objective of the verification activities was to confirm (1) that available documentation adequately and accurately describes the post-remedial action radiological conditions of the entire property that is to be certified and (2) that the remedial action reduced contamination levels to within authorized limits.

Document Reviews

Review of the designation/characterization report³ prepared by BNI indicates that the contamination was a shallow deposit and most likely created by runoff from the Ballod property; thus, it was appropriate to designate this property for remedial action.

The post-remedial action report⁴ indicates that the area excavated on this property was as identified in the designation report. The post-remedial action survey was performed on this property as described for a generic site in Ref. 5. This survey consists of ground-level beta-gamma measurements, surface gamma measurements, and systematic soil sampling. From the review of the post-remedial action report, it can be concluded that the BNI survey procedure used for this property is satisfactory. All reported ²³⁸U, ²²⁶Ra, and ²³²Th soil sample concentrations are below the average guideline limits set by DOE (Table 1).

VERIFICATION SURVEY AND ANALYSIS

Typical background radiation levels for the Rochelle Park, New Jersey, area are presented in Table 2. The data are provided for purposes of comparison with the survey results presented in this section.

All measurements presented in this report are gross readings; background radiation levels have not been subtracted. Similarly, background concentrations have not been subtracted from radionuclide concentrations in soil samples.

Gamma Measurements

Results of grid point measurements made by BNI are presented in the confirmatory report (Ref. 4). Gamma measurements were made approximately 30 cm above each grid point using a Primary Excavation Control Instrument (PECI). Gamma exposure rates at 30 cm above ground surface ranged from 4265 to 7073 counts per minute (cpm). The maximum gamma exposure rate of 7073 cpm was measured in the excavated area at the back side of the property at approximately grid location E9223, N8946. It was indicated by BNI that, on this site, a reading of 13,000 cpm on the Peci corresponds to a concentration of 5 pCi of ^{232}Th per gram of soil.

One pressurized ionization chamber (PIC) reading was taken at this property by BNI. The result and the location of the reading are presented in Table 3. The gamma exposure rate at 1 m above ground surface was 11 $\mu\text{R}/\text{h}$ (microroentgens* per hour).

Soil Sampling

Before backfilling, five soil samples were taken by BNI in the excavated area. The procedures used for soil sample analysis have been described in Ref. 3. Results of the soil sample analysis and the locations of the samples are given by BNI in the post-remedial confirmatory report.

Two of the five systematic soil samples from different locations and various depths were selected for independent verification by ORNL (see Table 4). The two samples have been analyzed for ^{238}U , ^{226}Ra , and ^{232}Th according to the procedure described in Ref. 6.

Concentrations of ^{238}U in the soil samples ranged from 0.74 to 0.95 pCi/g (picocuries† per gram) and averaged 0.84 pCi/g. Concentrations of ^{226}Ra in the soil samples ranged from 0.60 to 0.77 pCi/g and averaged 0.68 pCi/g. Concentrations of ^{232}Th in the soil samples ranged from 0.97 to 0.98 pCi/g, averaging 0.98 pCi/g. Locations of the soil samples are shown in Fig. 3. Results of ORNL analyses for the aforementioned two soil samples are given in Table 4, with results by BNI in parentheses for comparison. The significance of difference between these two sets of numbers was tested by single-sample *t*-test assuming ratios of paired values are log normally distributed. For 2 degrees of freedom, the *P* value (i.e., the likelihood of the ratio being other than zero) for ^{226}Ra and for ^{232}Th is 0.1 and 0.4, respectively. Such small *P* values indicate that the difference between these two sets of numbers is insignificant. Because BNI's results for ^{238}U were not absolute (see Table 4), no statistical test was performed for this radionuclide.

*The roentgen (R) is a unit which was defined for radiation protection purposes for people exposed to penetrating X rays or gamma radiation. A microroentgen (μR) is one millionth of a roentgen. A milliroentgen (mR) is one thousandth of a roentgen or one thousand microroentgens.

†The curie is a unit used to define the radioactivity in a substance and equals that quantity of any radioactive isotope undergoing 2.2×10^{12} disintegrations per minute. The picocurie is one million-millionth of a curie or that amount yielding 2.2 disintegrations per minute.

CONCLUSION

Measurements of the gamma exposure levels taken from the excavated area before backfilling determined that the exposure rate at 1 m above the ground surface was 11 $\mu\text{R}/\text{h}$. For comparison, the background for the state of New Jersey^{7,8,9} averages $\sim 8 \mu\text{R}/\text{h}$ and ranges from 6 to 11 $\mu\text{R}/\text{h}$ based on 1968 measurements. The results of soil radionuclide analyses for ^{238}U , ^{226}Ra , and ^{232}Th show that all soil concentration measurements are within the limits prescribed by DOE radiological guidelines.¹⁰

Based upon the results of the post-remedial action data, which were confirmed by the verification survey data, soil concentration measurements fall well below the limits prescribed by DOE radiological guidelines established for this site. It is concluded that the site successfully meets the DOE remedial action objectives.

REFERENCES

1. L. W. Cole, J. Berger, P. Cotten, R. Gosslee, L. Sowell, and C. Weaver. *Radiological Assessment of Ballod Associates Property (Stepan Chemical Company), Maywood, New Jersey*, Oak Ridge Associated Universities, Oak Ridge, Tenn., July 30, 1981.
2. H. W. Morton, *Natural Thorium in Maywood, New Jersey*, Nuclear Safety Associates, Inc., Potomac, Md., September 29, 1982.
3. *Radiological Survey Report for Maywood Vicinity Properties on Grove Avenue and Park Way, Maywood, New Jersey*, Bechtel National, Inc., Advanced Technology Division, Oak Ridge, Tenn., DOE/OR/20722-11, June 1984.
4. *Post-Remedial Action Report for the Residential Properties on Grove Avenue and Parkway, Rochelle Park, New Jersey*, Bechtel National, Inc., Advanced Technology Division, Oak Ridge, Tenn., DOE/OR/20722-83, March 1986.
5. *Remedial Action Work Plan for the Maywood Site*, U.S. Department of Energy, Oak Ridge Operations, Oak Ridge, Tenn., ORO-850, Rev. 1, April 1985.
6. T. E. Myrick, B. A. Berven, W. D. Cottrell, W. A. Goldsmith, and F. F. Haywood, *Procedures Manual for the Remedial Action Survey and Certification Activities (RASCA) Program*, Oak Ridge National Laboratory, ORNL/TM-8600, September 1982.
7. U.S. Department of Energy, *Radiological Survey of the Middlesex Municipal Landfill, Middlesex, New Jersey*, DOE/EV-0005/20, April 1980.
8. S. G. Levin, R. K. Stoms, E. Kuerze, and W. Huskisson, "Summary of Natural Environmental Gamma Radiation Using a Calibrated Portable Scintillation Counter," *Radiological Health Data Report* 9:679-695 (1968).
9. C. L. Lindekin, K. R. Peterson, D. E. Jones, and R. E. McMillen, "Geographical Variations in Environmental Radiation Background in the United States." *Proceedings of the Second International Symposium on the Natural Radiation Environment*, CONF-720805-P-1, pp. 317-331 (1972).
10. U.S. Department of Energy, *Guidelines for Residual Radioactivity at Formerly Utilized Sites Remedial Action Program and Remote Surplus Facilities Management Program Sites*, Rev. 1, July 1985.

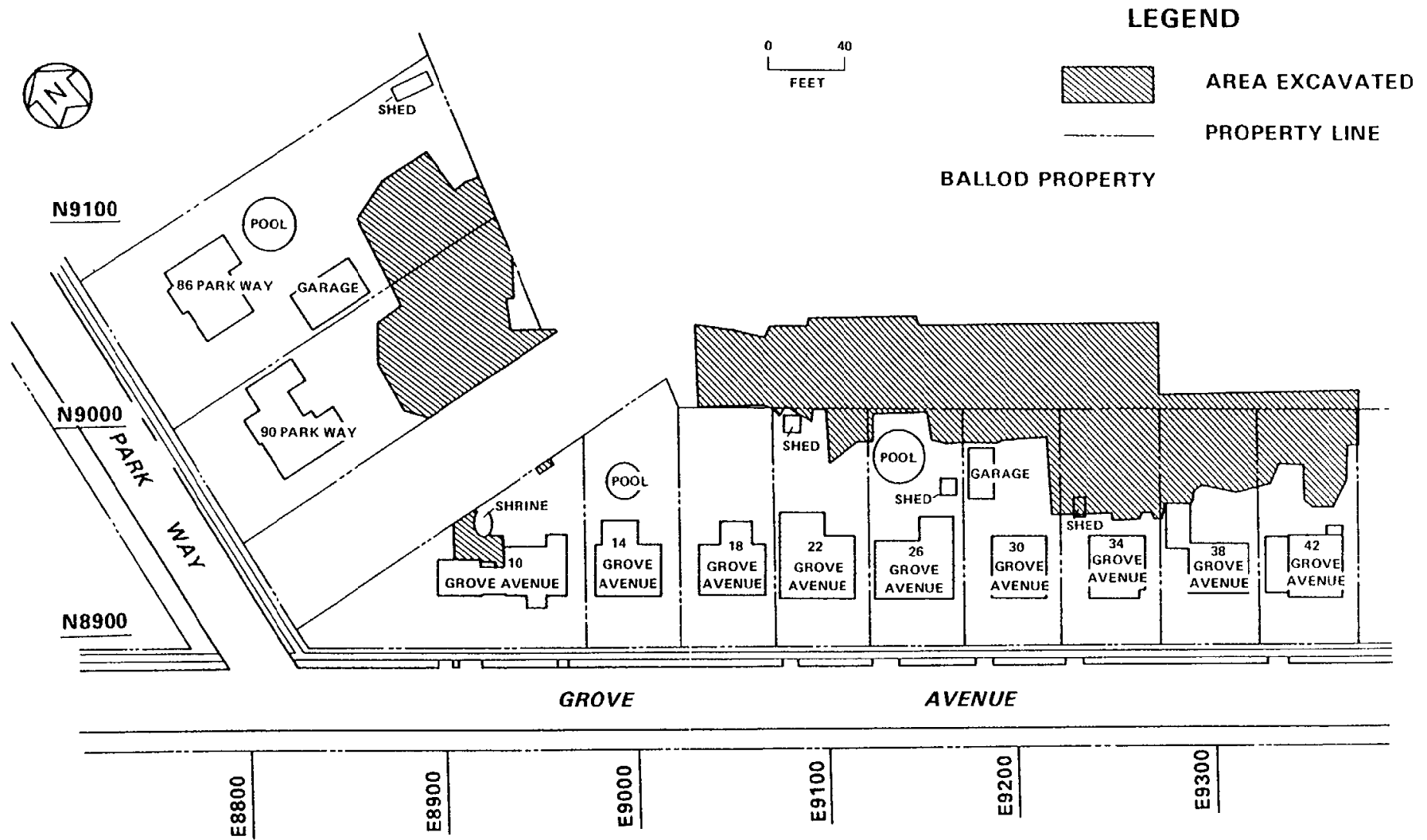

Fig. 1. Vicinity properties in the Rochelle Park, New Jersey, area.

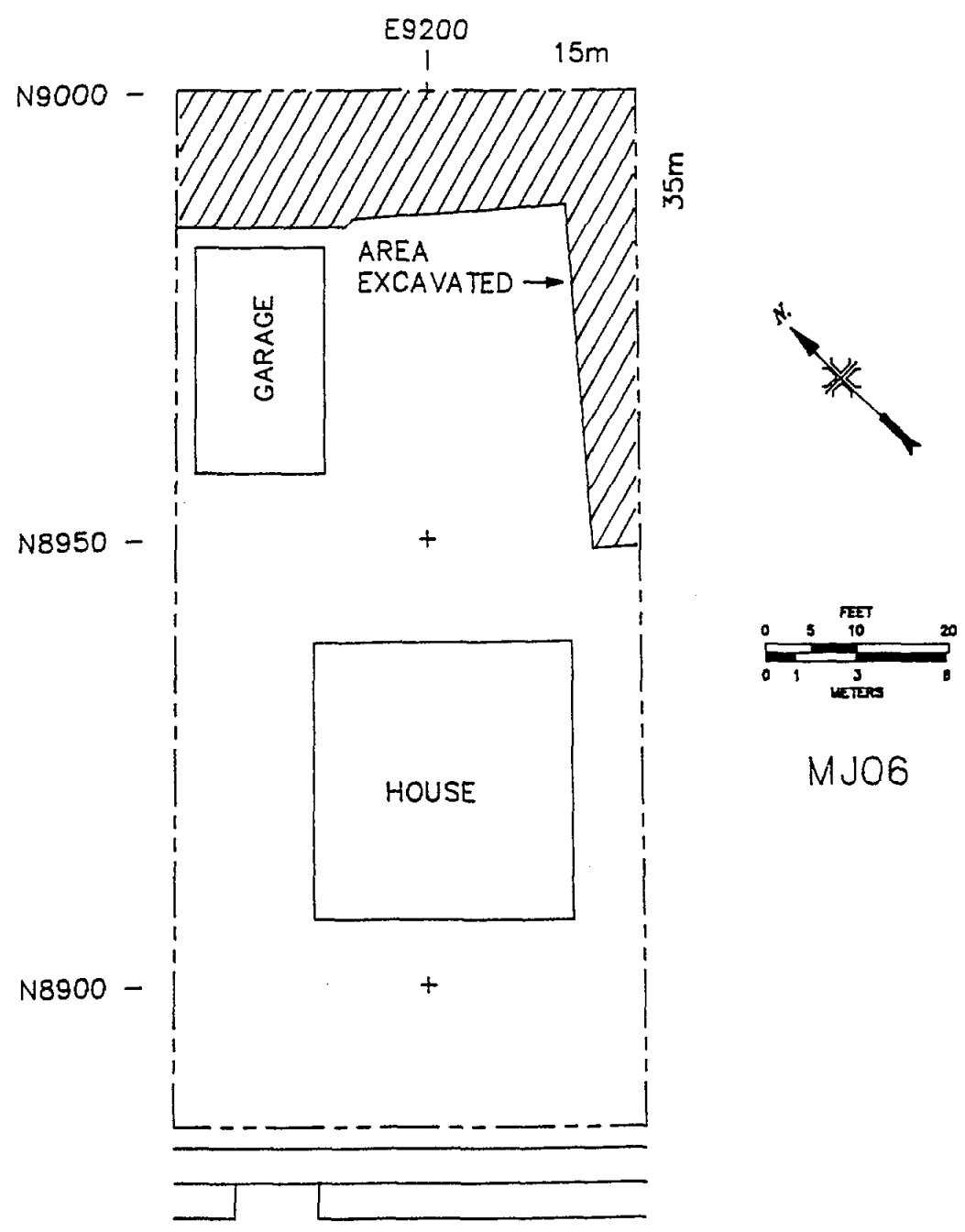

Fig. 2. Diagram showing grid point and grid block locations outdoors on the property at 30 Grove Ave., Rochelle Park, New Jersey (MJ06L).

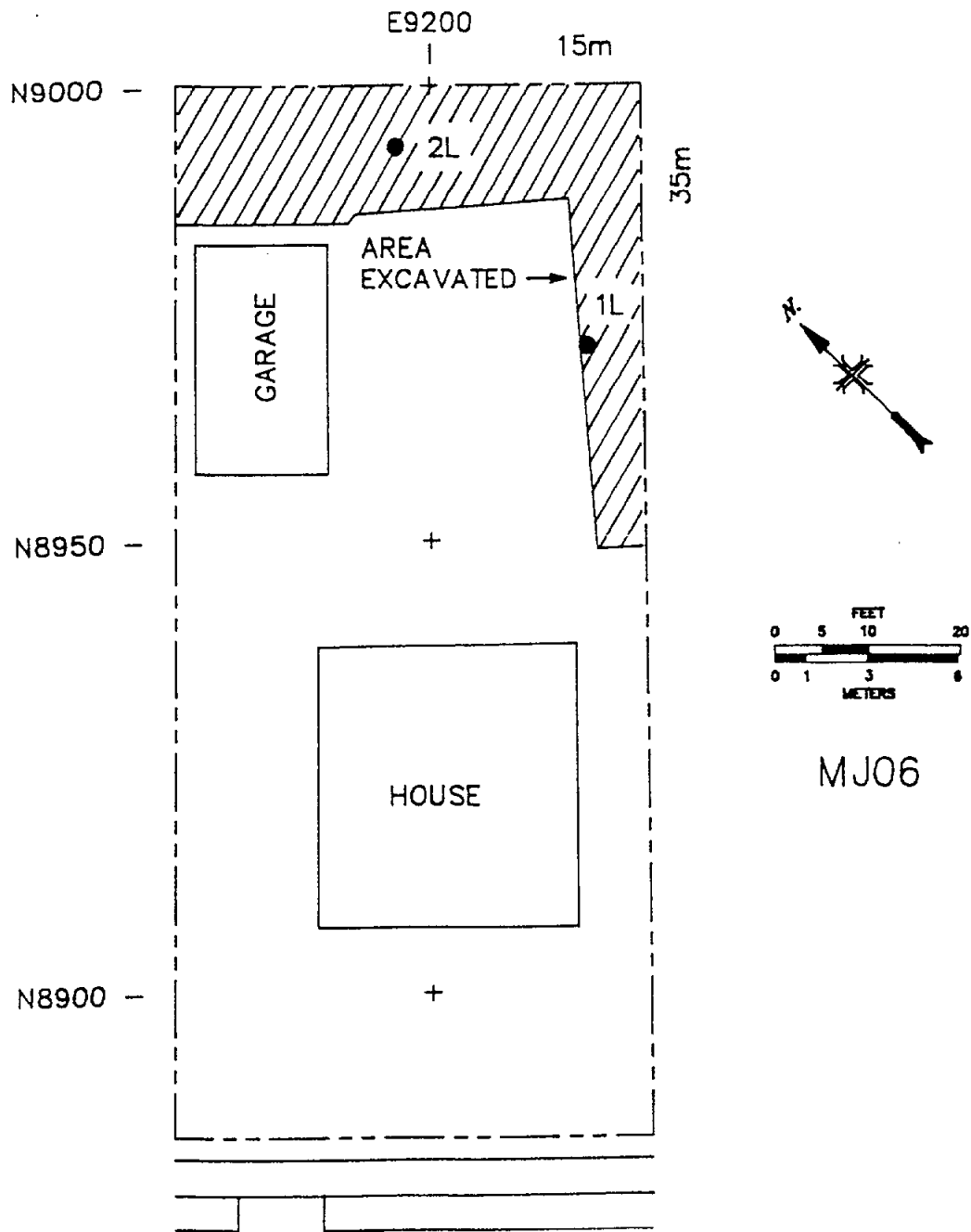

Fig. 3. Locations of soil samples on the property at 30 Grove Ave., Rochelle Park, New Jersey (MJ06L).

Table 1. Summary of residual contamination guidelines
for the Rochelle Park, New Jersey, site

Soil (Land) Guidelines (Maximum Limits for Unrestricted Use)	
Radionuclide	Soil concentration (pCi/g) above background ^{a,b,c}
²²⁶ Ra	5 pCi/g, averaged over the first 15 cm of soil below the surface; 15 pCi/g when averaged over any 15-cm-thick soil layer below the surface layer
²²⁸ Ra	
²³⁰ Th	
²³² Th	
Other radionuclides	Soil guidelines will be calculated on a site-specific basis using the DOE manual developed for this use

Structure Guidelines (Maximum Limits for Unrestricted Use)

Indoor Radon Decay Products

For ²²²Ra and ²²⁰Rn concentrations in buildings, the average annual radon decay product concentration (including background) due to uranium or thorium by-products should not exceed 0.02 WL after remedial action. When remedial action has been performed and it would be unreasonably difficult and costly to reduce the level below 0.03 WL, the remedial action may be terminated, and the reasons for termination should be documented. Remedial action shall be undertaken for any building that exceeds an annual average radon decay product concentration (including background) of 0.03 WL.

Indoor Gamma Radiation

The indoor gamma radiation after decontamination shall not exceed 20 microroentgen per hour (20 μ R/h) above background in any occupied or habitable building.

Indoor/Outdoor Structure Surface Contamination

Radionuclide ^e	Allowable Surface Residual Contamination ^d (dpm/100 cm ²)		
	Average ^{f,g}	Maximum ^f	Removable ^f
Transuranics, ²²⁶ Ra, ²²⁸ Ru, ²³⁰ Th, ²²⁸ Th, ²³¹ Pa, ²²⁷ Ac, ¹²⁵ I, ¹²⁹ I	100	300	20
Natural Th, ²³² Th, ⁹⁰ Sr, ²²³ Ra, ²²⁴ Ra, ²³² U, ¹²⁶ I, ¹³¹ I, ¹³³ I	1,000	3,000	200
Natural U, ²³⁵ U, ²³⁸ U, and associated decay products	5,000	15,000	1,000

Table 1 (continued)

Radionuclide ^e	Allowable Surface Residual Contamination ^d (dpm/100 cm ²)		
	Average ^{f,g}	Maximum ^f	Removable ^f
Beta-gamma emitters (radionuclides with decay modes other than alpha emission or spontaneous fission) except ⁹⁰ Sr and others noted above	5,000	15,000	1,000

^aIn the event of occurrence of mixtures of radionuclides, the fraction contributed by each radionuclide to its limit shall be determined, and the sum of these fractions shall not exceed 1.

^bThese guidelines represent unrestricted-use residual concentrations above background averaged across any 15-cm thick layer to any depth and over any contiguous 100-m² surface area.

^cLocalized concentrations in excess of these limits are allowable provided that the average over 100 m² is not exceeded.

^dAs used in this table, dpm (disintegrations per minute) means the rate of emission by radioactive material as determined by correcting the counts per minute observed by an appropriate detector for background, efficiency, and geometric factors associated with the instrumentation.

^eWhere surface contamination by both alpha- and beta-gamma-emitting radionuclides exists, the limits established for alpha- and beta-gamma-emitting radionuclides shall apply independently.

^fMeasurements of average contaminant should not be averaged over more than 1 m². For objects of less surface area, the average shall be derived for each such object.

^gThe average and maximum radiation levels associated with surface contamination resulting from beta-gamma emitters should not exceed 0.2 mrad/h at 1 cm and 1.0 mrad/h at 1 cm, respectively, measured through not more than 7 mg/cm² of total absorber.

Table 2. Background radiation levels in the Rochelle Park, New Jersey, area

Type of radiation measurement or sample	Radiation level or radionuclide concentration	
	Range	Average
Gamma exposure rate at 1 m above floor or ground surface ($\mu\text{R}/\text{h}$) ^a	8-11	9
Concentration of radionuclides in soil (pCi/g) ^b		
²³⁸ U	0.13-1.4	0.86
²²⁶ Ra	0.24-1.4	0.87
²³² Th	0.31-1.5	0.9

^aValues obtained from 35 locations in the Rochelle Park area.⁸

^bSoil samples obtained from locations around the Maywood area.⁶

Table 3. Result and location of the pressurized ionization chamber (PIC) measurement at 30 Grove Ave., Rochelle Park, New Jersey (MJ06L)^a

Coordinates		Gamma exposure rate ($\mu\text{R}/\text{h}$)
East	North	
9200	8995	11

^aRef. 4.

Table 4. Results of soil sample analysis at 30 Grove Ave.,
Rochelle Park, New Jersey (MJ06L)

Sample	Location ^a		Depth (cm)	Radionuclide concentration (pCi/g)		
	East	North		²²⁶ Ra ^b	²³² Th ^c	²³⁸ U ^d
Systematic Samples^e						
1L	9220	8970	45-60	0.6 ± 0.06 (0.7) ^f	0.97 ± 0.04 (1.0) ^f	0.95 ± 0.59 (1.0) ^f
2L	9200	8990	15-30	0.77 ± 0.07 (0.8) ^f	0.98 ± 0.04 (0.8) ^f	0.74 ± 0.67 (0.8) ^f

^aLocations of soil samples are shown on Fig. 3.

^bIndicated counting error is at the 95% confidence level ($\pm 2\sigma$).

^cIndicated counting error is at the 95% confidence level ($\pm 2\sigma$).

^dAnalytical error of measurement results is less than $\pm 5\%$ (95% confidence level).

^eSystematic samples are taken at grid locations irrespective of gamma exposure.

^fBNI results are shown in parentheses.

INTERNAL DISTRIBUTION

- | | |
|-------------------|------------------------------|
| 1. B. A. Berven | 7-11. P. T. Owen |
| 2. R. O. Chester | 12. T. H. Row |
| 3. W. D. Cottrell | 13-17. M. G. Yalcintas |
| 4. C. A. Johnson | 18. IR&A Publications Office |
| 5. S. V. Kaye | 19. Laboratory Records - RC |
| 6. J. L. Marley | |

EXTERNAL DISTRIBUTION

- 20-24. S. W. Ahrends, U.S. Department of Energy, Technical Services Division, Oak Ridge Operations Office, Oak Ridge, TN 37831
25. J. D. Berger, Oak Ridge Associated Universities, P.O. Box 117, Oak Ridge, TN 37831
- 26-28. E. G. DeLaney, U.S. Department of Energy, Director, Division of Facilities and Site Decommissioning Projects, Office of Nuclear Energy, 19901 Germantown Road, Germantown, MD 20874
- 29-31. C. E. Miller, U.S. Department of Energy, Director, Surplus Facilities Management, Richland Operations Office, P.O. Box 550, Richland, WA 99352
- 32-33. J. F. Nemeec, Bechtel National, Inc., 800 Oak Ridge Turnpike, Oak Ridge, TN 37831
34. J. W. Wagoner II, U.S. Department of Energy, Division of Facilities and Site Decommissioning Projects, Office of Nuclear Energy, 19901 Germantown Road, Germantown, MD 20874
35. A. Wallo, Aerospace Corporation, Environmental and Conservation Directorate, 955 L'Enfant Plaza, SW, Suite 4000, Washington, DC 20024
36. Office of Assistant Manager, Energy Research and Development, Oak Ridge Operations Office, Oak Ridge, TN 37831
- 37-38. Office of Scientific and Technical Information, U.S. Department of Energy, Oak Ridge, TN 37831